

Inkommet
 2018-07-02
 Diarienum: 2018-0467

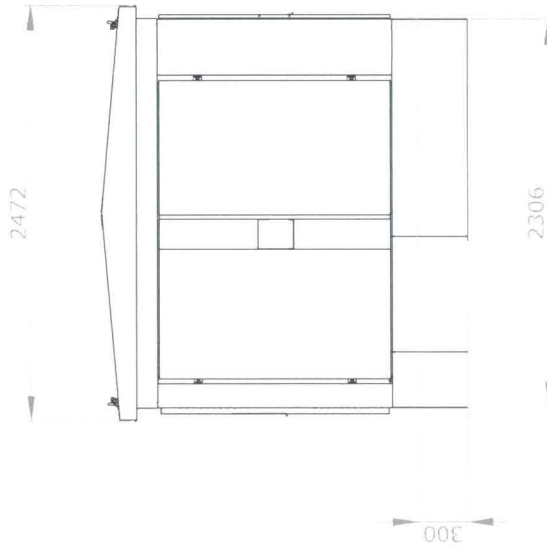

Mått i mm.	
Totallängd:	2899
Totalbredd:	2472
Totalhöjd:	2184
Höjd över mark, ca:	1884
Taklutning:	5°
Fundamentshöjd:	450

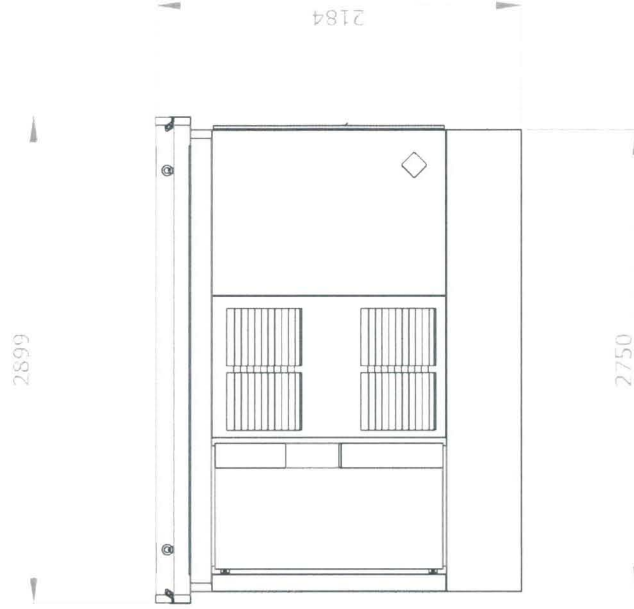
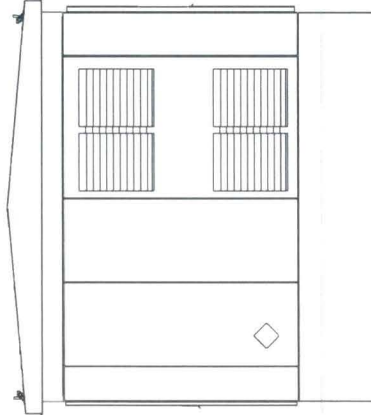
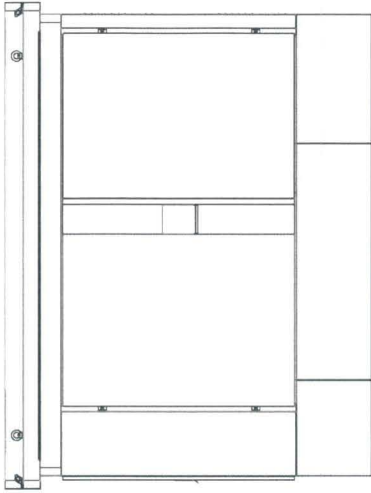

Nätstation
ZN22-RMU-BF-315

Sign	ES	Gråk	KA	Format	A3	Skala	1:30	Datum	20180323
Nr.								Side/Anfall	1/1

OF-277